

# CUSHION CLAMPS FOR PIPE & TUBE

## SINGLE AND SINGLE STACK CUSHION CLAMPS

Cushion Clamps assemblies are designed to resist crushing while absorbing shock and suppressing vibration and noise.

### Standard Features:

- Low temperature impact resistance
- Long life to temperature of 220°F (120° C)
- Remains stable in light acids, solvents, fuels, mineral oils, alcohol, paints, and salt water
- Single clamp sizes from 1/8 inch to 4 inch pipe and .25 inch to 4.5 inch tube/hose
- Stack/twin clamp sizes up to 2 inch pipe and up to 2.5 inch tube/hose

### Standard Materials:

- Cushions made of high impact copolymer
- Zinc plated steel hardware



## SINGLE AND SINGLE STACK CLAMP SERIES A

## .125 thru .750 SERIES AA

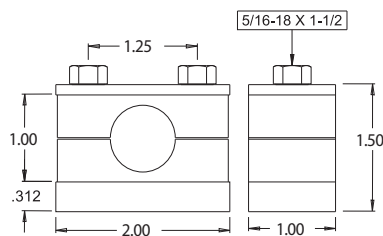

NOTE: All dimensions are inches

Series A and Series AA			
Nominal Pipe Size	Part No.	Tube/Hose OD (inches)	Part No.
1/8	12P	.25	25T
1/4	25P	.50	50H
3/8	37P	.56	56H
		.62	62H
		.69	68H
		.75	75H

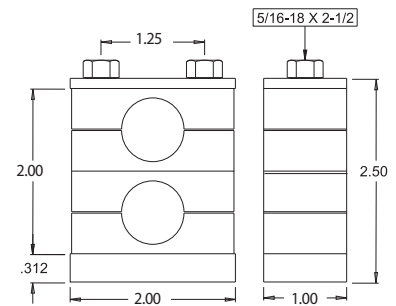

## SINGLE AND SINGLE STACK CLAMP SERIES B

## .500 thru 1.00 SERIES BB

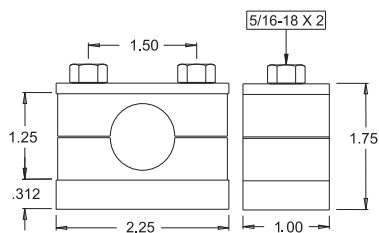

NOTE: All dimensions are inches

Series B and Series BB			
Nominal Pipe Size	Part No.	Tube/Hose OD (inches)	Part No.
1/2	50P	.81	81H
3/4	75P	.88	87H
		.94	93H
		1.00	100H

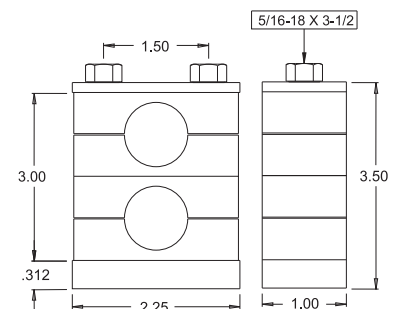

### How to Order

Example: single clamp A25TH  
single stack clamp BB100H100HH

Series Part Number H = All Hardware  
C = Cushion half

Dimensions and specifications are subject to change without notice. Not all items are Made-To-Stock, contact us for availability.

10/14

Ph : 920-682-6877  
Fx : 920-684-7210

**LDI** Industries

sales@ldi-industries.com  
www.ldi-industries.com

# CUSHION CLAMPS FOR PIPE & TUBE

## SINGLE AND SINGLE STACK CLAMP

### SERIES C

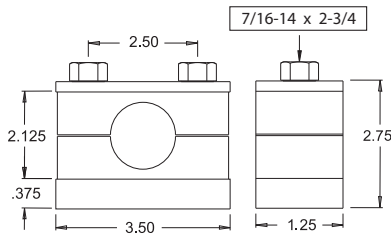

NOTE: All dimensions are inches

Series C and Series CC			
Nominal Pipe Size	Part No.	Tube/Hose OD (inches)	Part No.
1	100P	1.06	106H
		1.12	112H
		1.19	118H
		1.25	125H
		1.31	131H
		1.38	137H
		1.44	143H
		1.50	150H

## 1.00 thru 1.50

### SERIES CC

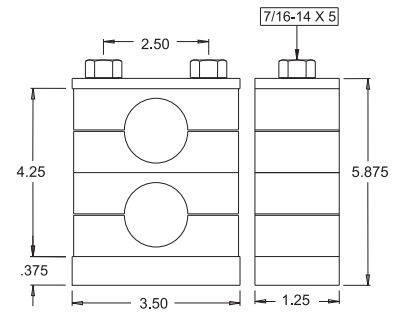

## SINGLE AND SINGLE STACK CLAMP

### SERIES D

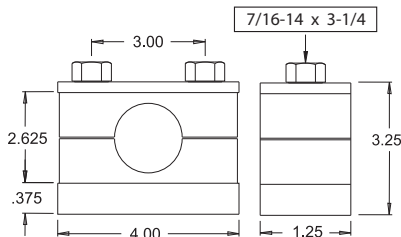

NOTE: All dimensions are inches

Series D and Series DD			
Nominal Pipe Size	Part No.	Tube/Hose OD (inches)	Part No.
1 1/4	125P	1.56	156H
1 1/2	150P	1.62	162H
		1.69	168H
		1.75	175H
		1.81	181H
		1.88	187H
		1.94	193H
		2.00	200H

## 1.25 thru 2.00

### SERIES DD

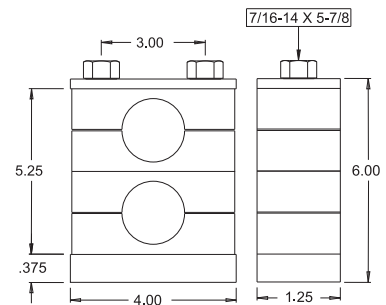

## SINGLE AND SINGLE STACK CLAMP

### SERIES E

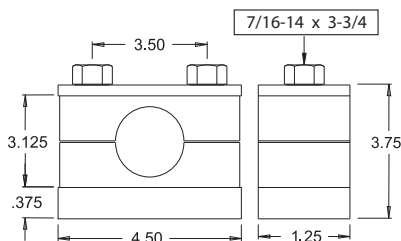

NOTE: All dimensions are inches

Series E and Series EE			
Nominal Pipe Size	Part No.	Tube/Hose OD (inches)	Part No.
2	200P	2.06	206H
		2.12	212H
		2.19	218H
		2.25	225H
		2.31	231H
		2.38	237H
		2.44	243H
		2.50	250H

## 2.00 thru 2.50

### SERIES EE

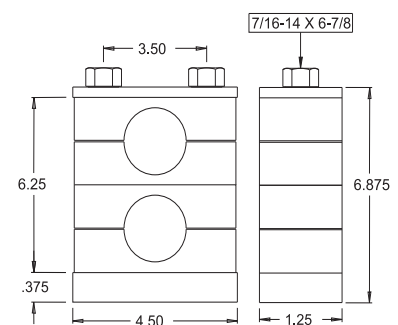

#### How to Order

Example: single clamp D125PH  
single stack clamp EE225H250HH

Series Part Number H = All Hardware  
C = Cushion half

Dimensions and specifications are subject to change without notice. Not all items are Made-To-Stock, contact us for availability.

10/14

Ph : 920-682-6877  
Fx : 920-684-7210



sales@ldi-industries.com  
www.ldi-industries.com

# CUSHION CLAMPS FOR PIPE & TUBE

## TWIN AND TWIN STACK CLAMP SERIES F

## .125 thru .750 SERIES FF

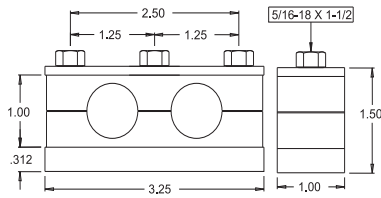

NOTE: All dimensions are inches

Series F and Series FF			
Nominal Pipe Size	Part No.	Tube/Hose OD (inches)	Part No.
1/8 x 1/8	1212P	.25-.25	2525T
1/4 x 1/4	2525P	.50-.50	5050H
3/8 x 3/8	3737P	.56-.56	5656H
		.62-.62	6262H
		.69-.69	6868H
		.75-.75	7575H

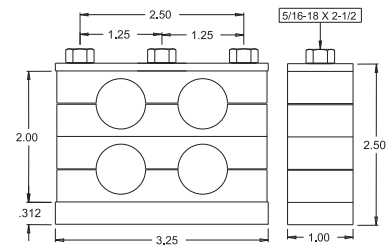

## TWIN AND TWIN STACK CLAMP SERIES G

## .500 thru 1.00 SERIES GG

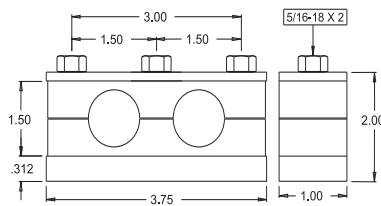

NOTE: All dimensions are inches

Series G and Series GG			
Nominal Pipe Size	Part No.	Tube/Hose OD (inches)	Part No.
1/2 x 1/2	5050P	.81-.81	8181H
3/4 x 3/4	7575P	.88-.88	8787H
		.94-.94	9393H
		1.00-1.00	1010H

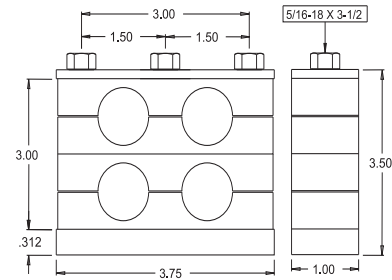

## TWIN AND TWIN STACK CLAMP SERIES L

## 1.00 thru 1.50 SERIES LL

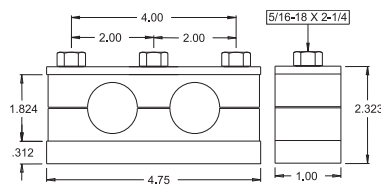

NOTE: All dimensions are inches

Series L and Series LL			
Nominal Pipe Size	Part No.	Tube/Hose OD (inches)	Part No.
1 x 1	1010P	1.06-1.06	106106H
		1.12-1.12	112112H
		1.19-1.19	118118H
		1.25-1.25	125125H
		1.31-1.31	131131H
		1.38-1.38	137137H
		1.44-1.44	143143H
		1.50-1.50	150150H

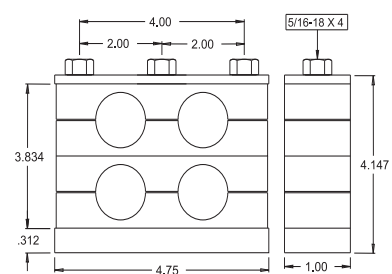

### How to Order

Example: twin clamp G7575PH  
twin stack clamp FF5050H2525TH

Series Part Number H = All Hardware  
C = Cushion half

Dimensions and specifications are subject to change without notice. Not all items are Made-To-Stock, contact us for availability.

03/16

Ph : 920-682-6877  
Fx : 920-684-7210

**LDI** Industries

sales@ldi-industries.com  
www.ldi-industries.com

Pg RA-33

# CUSHION CLAMPS FOR PIPE & TUBE

## MINI TWIN & MINI TWIN STACK CLAMP SERIES M

.125 thru 5.00  
SERIES MM

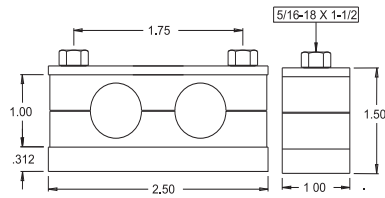

NOTE: All dimensions are inches

Series M and Series MM			
Nominal Pipe Size	Part No.	Tube/Hose OD (inches)	Part No.
1/8 x 1/8	1212P	.25-.25	2525T
1/4 x 1/4	2525P	.50-.50	5050T

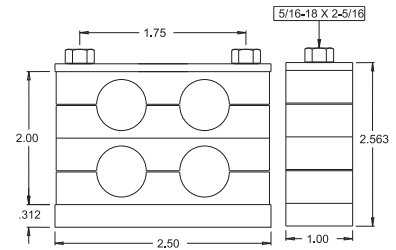

### How to Order

Example: mini twin clamp M5050TH  
mini twin stack clamp MM2525T5050TH

Series Part Number H = All Hardware  
C = Cushion half

## SINGLE CLAMP SERIES K

2.50 thru 3.00

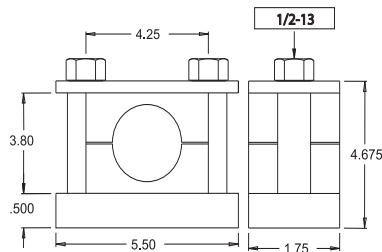

NOTE: All dimensions are inches

Series K - 2.50 thru 3.00			
Nominal Pipe Size	Part No.	Tube/Hose OD (inches)	Part No.
2 1/2	250P	3.00	300T

### How to Order

Example: K250PH

K  
Series Part Number H = All Hardware  
C = Cushion half

## SINGLE CLAMP SERIES K

3.00 thru 3.50

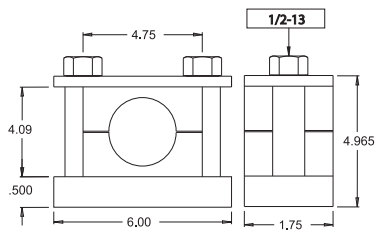

NOTE: All dimensions are inches

Series K - 3.00 thru 3.50			
Nominal Pipe Size	Part No.	Tube/Hose OD (inches)	Part No.
3.00	300P	3.50	300P

### How to Order

Example: K300PH

K  
Series Part Number H = All Hardware  
C = Cushion half

## SINGLE CLAMP SERIES K

4.00 thru 4.50

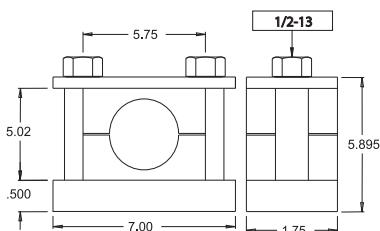

NOTE: All dimensions are inches

Series K - 4.00 thru 4.50			
Nominal Pipe Size	Part No.	Tube/Hose OD (inches)	Part No.
4.00	400P	4.00	400T
		4.50	400P

### How to Order

Example: K400PH

K  
Series Part Number H = All Hardware  
C = Cushion half

Dimensions and specifications are subject to change without notice. Not all items are Made-To-Stock, contact us for availability.

03/15

Ph : 920-682-6877  
Fx : 920-684-7210

**LDI** Industries

sales@ldi-industries.com  
www.ldi-industries.com