

LIQUID LEVEL GAGE - BACK MOUNT, DIAL THERMOMETER

LDI INDUSTRIES' G632 series closed circuit, dual purpose liquid level gage with a 1.38 (35.05mm) diameter dial probe thermometer, offers 270° viewing of fluid level and temperature. This gage is especially suited for mounting in areas where there is danger of the gage being damaged. The sight and dial probe thermometer are recessed well into the heavy bar stock body for maximum protection. Mounting requires two .52 (13.21mm) diameter holes spaced at 5.00 (127.00mm) centers. Mounting studs accommodate tank walls through .50 (12.70mm) thickness. Available with 5.00 (127.00mm) centers only.

STANDARD MATERIALS:

- Aluminum construction
- Buna N seals
- Borosilicate glass with redline on white background for distinct level reading and maximum fluid compatibility

OPERATING CONDITIONS:

- Maximum working pressure up to 125 PSI (861.9 kPa) at 150°F (65.6°C), no corrosion

HOW TO ORDER:

WHEN ORDERING, SPECIFY THE FOLLOWING, AFTER THE SERIES NUMBER SEPARATING EACH WITH A DASH (-):

- A- Aluminum gage body (standard)
- 1- Buna N seals (standard)
- 2- Butyl seals (optional)
- 3- Viton A® seals (optional)
- 4- Ethylene Propylene seals (optional)
- 5- Silicone seals (optional)

EXAMPLE: G632-05-A-1 — Buna N seals
 — Aluminum gage body
 — Series G632 with 5.00 (127.00mm) centers

G632 PATENTED - 3 SIDES OPEN - 270° VIEWING

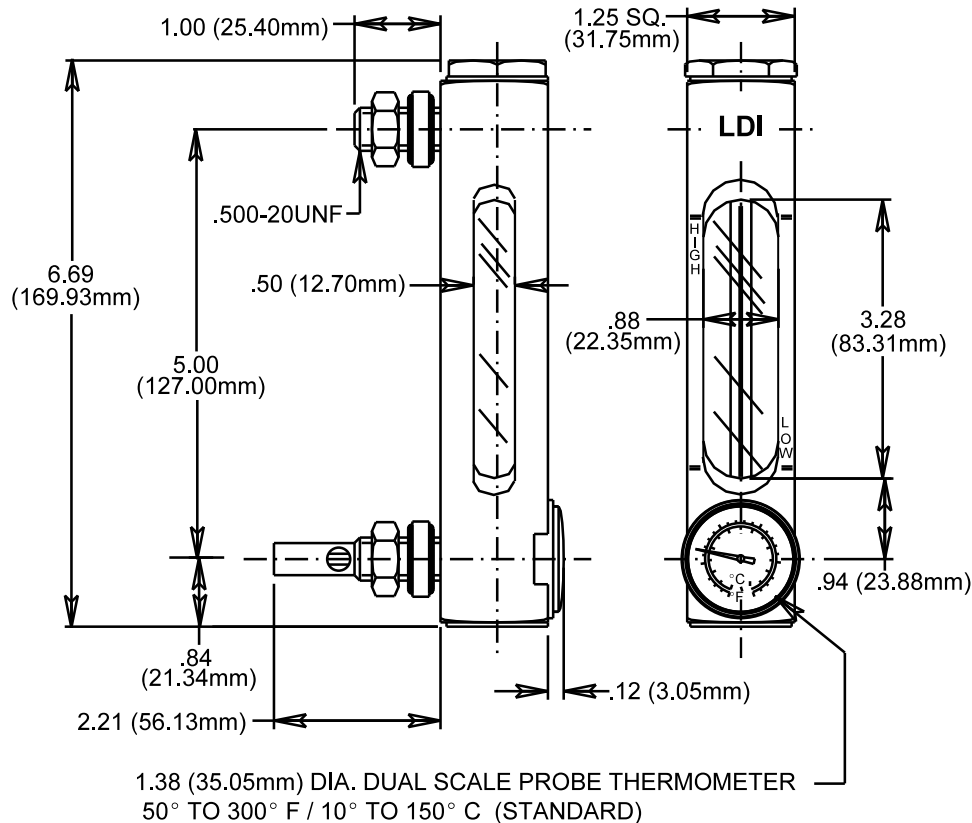

LIQUID LEVEL GAGE - BACK MOUNT,
DIAL THERMOMETER

5/07 **BULLETIN F327-32**

ISO9001:2000 CERTIFIED



Lube Devices • Flodar • Hydra-Tool • Vescor

1864 Nagle Ave. P. O. Box 1810

Manitowoc, WI 54221-1810

Phone: (920) 682-6877 Fax: (920) 684-7210

E-MAIL: sales@ldi-industries.com WEBSITE: www.ldi-industries.com