

RESERVOIRS - AIR / OIL - WALL MOUNT

Air / oil tanks provide precision hydraulic power from shop air. Exact cylinder movement is achieved without the high cost of conventional hydraulic power requiring pump, motor, filter, etc. Basic circuits, when used with low pressure hydraulic check, flow control and directional valves, allow oil (driven at 1:1 ratio) to force piston rod at the same speed through both forward and return stroke. The speed control is adjustable to your work requirement.

STANDARD MATERIALS:

- Aluminum construction
- Buna N seals
- Break resistant, colorless, transparent polymer

OPERATING CONDITIONS:

- Polymer up to 140°F (60°C)
- Aluminum up to 250°F (121.1°C)
- Maximum working pressure:
Polymer up to 60 PSI (413.7 kPa)
Aluminum up to 100 PSI (689.5 kPa)

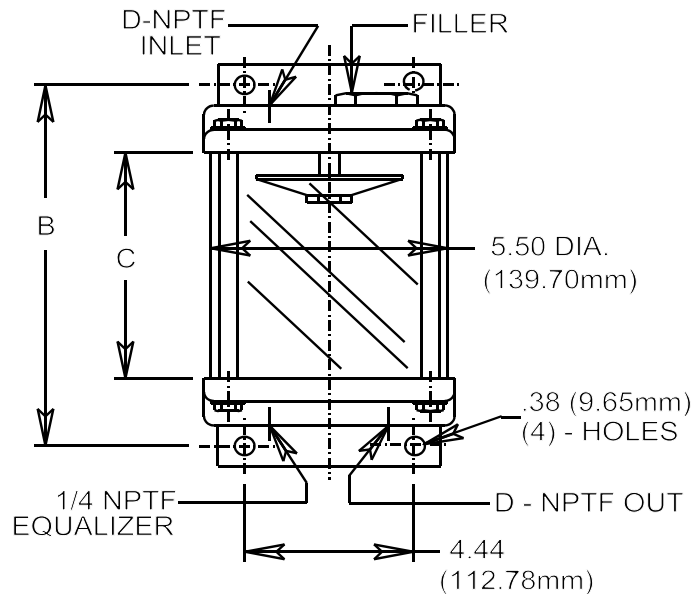
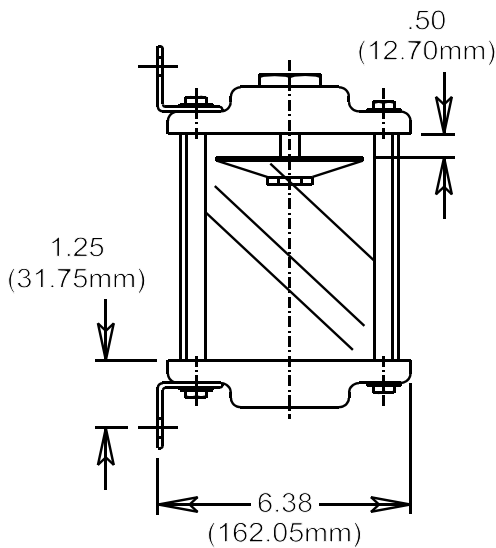

**MODIFICATIONS OF ALUMINUM BOWL OR ALUMINUM BOWL WITH GAGE AVAILABLE
CONSULT OUR FACTORY (MINIMUM ORDER MAY BE REQUIRED)**

CATALOG NUMBER		CAPACITY		B INCHES (mm)	C INCHES (mm)	D NPTF
POLYMER	ALUMINUM WITH GAGE	POLYMER	ALUMINUM			
A/OR5075-3	-	97.0 cu. in. (1589.5) cu. cm.	102.0 cu. in. (1671.5) cu. cm.	7.00 (177.80)	4.56 (115.82)	3/8
A/OR5100-3	-	127.0 cu. in. (2081.2) cu. cm.	133.0 cu. in. (2179.5) cu. cm.	8.50 (215.90)	6.06 (153.92)	3/8
-	A/OR15175-3	196.0 cu. in. (3211.9) cu. cm.	205.0 cu. in. (3359.3) cu. cm.	12.00 (304.80)	9.56 (242.82)	3/8
A/OR5200-3	-	220.0 cu. in. (3605.2) cu. cm.	231.0 cu. in. (3785.4) cu. cm.	13.25 (336.55)	10.75 (273.05)	3/8

RESERVOIRS - AIR / OIL
WALL MOUNT

3/04

BULLETIN F1077-2



LUBE DEVICES, INC.

1864 NAGLE AVE., P.O. BOX 1810, MANITOWOC, WI 54221-1810
PHONE: (920) 682-6877 FAX: (920) 684-7210
E-MAIL: sales@lubedevices.com WEBSITE: www.lubedevices.com