

FRONT MOUNTING LIQUID LEVEL GAGES - WITH AND WITHOUT THERMOMETER

A patented dual purpose closed circuit style liquid level gage that provides both instant and positive visual check of fluid levels and temperature in either hydraulic or oil reservoirs. Maximum sight protection is provided by the heavy precision machined bar stock body. Thermometer series gages have a protected sensing element that extends well into the tank - unaffected by unrelated ambient temperature. Gages are furnished complete including O-ring seals and hex nuts for mounting. A .06 (1.52mm) alignment adjustment at each stud facilitates mounting. This gage can be installed from the outside on 1/2-20UNF tapped holes when reservoirs do not have access to the interior and tank wall thickness permits tapping. For installations where gage is bolted to cylindrical tank wall, conical sleeves are available. **Please specify** when ordering. Front mounting gages can be made to order with mounting centers up to 142.00 (3606.80mm) in 1.00 (25.40mm) increments. Stainless steel dial thermometer: 1.38 (35.05mm) dia. dual scale Fahrenheit (50° to 300°), Centigrade (10° to 150°). For back mount gages see our SERIES G610 and G620 on Bulletin F327-10/-20.

STANDARD MATERIALS:

- Aluminum construction
- Buna N seals
- Borosilicate glass with redline on white background for distinct level reading and maximum fluid compatibility

OPERATING CONDITIONS:

- See ENG. STD. 109

HOW TO ORDER:

Use code letters for body material: Use code number for seal material:

- | | |
|--|---|
| A - Aluminum gage body (standard) | 1 - Buna N seals (standard) |
| B - Brass gage body (optional) | 2 - Butyl seals (optional) |
| S - Steel gage body (optional) | 3 - Viton A® seals (optional) |
| Y - Stainless Steel gage body (optional) | 4 - Ethylene propylene seals (optional) |
| | 10 - Neoprene seals (optional) |

First, specify series number, then mounting centers, then kind of metal, and finally seal material, separating each with a dash (-):

SERIES G605 WITHOUT THERM.	SERIES G615 WITH THERM.	A - CENTERS INCHES (mm)	B - SIGHT INCHES (mm)	C - LENGTH INCHES (mm)
G605	G615	03 (76.20)	1.50 (38.10)	4.62 (117.35)
G605	G615	04 (101.60)	2.50 (63.50)	5.62 (142.75)
G605	G615	05 (127.00)	3.50 (88.90)	6.62 (168.15)
G605	G615	06 (152.40)	4.50 (114.30)	7.62 (193.55)
G605	G615	07 (177.80)	5.50 (139.70)	8.62 (218.95)
G605	G615	08 (203.20)	6.50 (165.10)	9.62 (244.35)
G605	G615	09 (228.60)	7.50 (190.50)	10.62 (269.75)
G605	G615	10 (254.00)	8.50 (215.90)	11.62 (295.15)
G605	G615	11 (279.40)	9.50 (241.30)	12.62 (320.55)
G605	G615	12 (304.80)	10.50 (266.70)	13.62 (345.95)

EXAMPLE: G615-05-A-1
 BUNA N seals
 Aluminum gage body
 5.00 (127.00mm) Centers
 SERIES G615

NOTE: The sight opening in all cases is 1.50 (38.10mm) less than mounting centers and overall length is 1.62 (41.15mm) greater than mounting centers. Gages with 13.00 (330.20mm) and greater mounting centers are furnished with spacer sleeves to space gage from tank allowing for bowing of the tank wall in larger reservoirs. Center mounting kits are furnished with gages 48.00 (1219.20mm) and greater mounting centers.

SERIES G605 - SIGHT ONLY

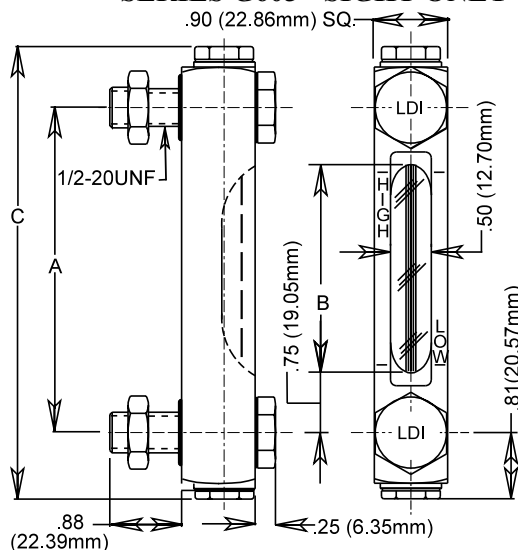

SERIES G615 WITH DIAL THERMOMETER

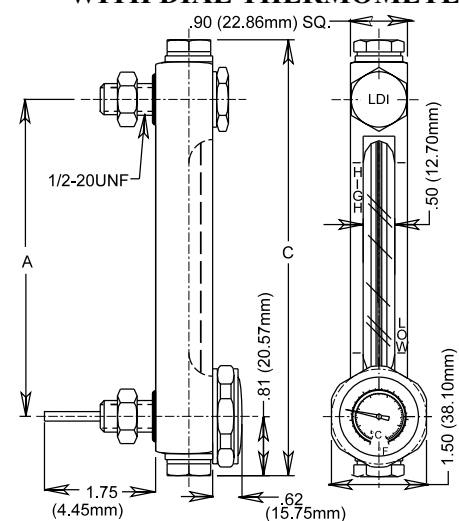

Lube Devices • Flodar • Hydra-Tool • Vescor
 1864 Nagle Ave. P. O. Box 1810
 Manitowoc, WI 54221-1810
 Phone: (920) 682-6877 Fax: (920) 684-7210
 E-MAIL: sales@ldi-industries.com WEBSITE: www.ldi-industries.com

FRONT MOUNTING LIQUID LEVEL GAGES - WITH AND WITHOUT THERMOMETER
 7/06 BULLETIN F327-5 / -15
 ISO9001:2000 CERTIFIED