

LDI PORT FITTINGS

MAC3000 SERIES

The MAC3000 Series tee shaped adapter is made up of two opposing male 37°JIC tube connections per SAE J514 and a male LDI Port stem swivel connection forming the leg. The swivel connection allows the orientation of the male 37° connections to be fixed while the swivel nut on the LDI Port stem is tightened.

Standard Features:

- Tube sizes from -4 (.25 inch) to -32 (2.00 inch)
- Copper brazed construction
- Hardened port stem

Standard Materials:

- Steel construction
- Black oxide finish

CAUTION

- System operating conditions and maximum pressures dictate tubing requirements

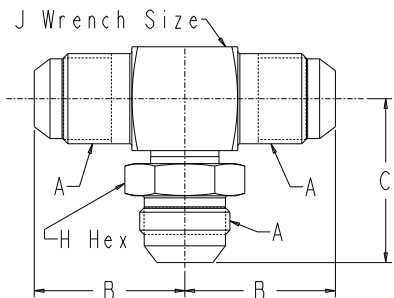

MAC3000 Series (inches)

Part No.	Tube OD	A	B	C	J	H
MAC3000-4	1/4	7/16-20	0.89	1.16	7/16	9/16
MAC3000-6	3/8	9/16-18	1.06	1.36	9/16	11/16
MAC3000-8	1/2	3/4-16	1.25	1.52	3/4	7/8
MAC3000-10	5/8	7/8-14	1.45	1.64	7/8	1
MAC3000-12	3/4	1 1/16-12	1.66	1.91	1 1/8	1 1/4
MAC3000-14	7/8	1 3/16-12	1.72	2.00	1 1/4	1 3/8
MAC3000-16	1	1 5/16-12	1.81	2.16	1 3/8	1 1/2
MAC3000-20	1 1/4	1 5/8-12	2.06	2.50	1 3/4	1 3/4
MAC3000-24	1 1/2	1 7/8-12	2.33	2.73	2	2
MAC3000-32	2	2 1/2-12	3.06	3.33	2 1/2	2 3/4

Dimensions and specifications are subject to change without notice. Not all items are Made-To-Stock, contact us for availability.

02/14

Ph : 920-682-6877
Fx : 920-684-7210



sales@ldi-industries.com
www.ldi-industries.com